

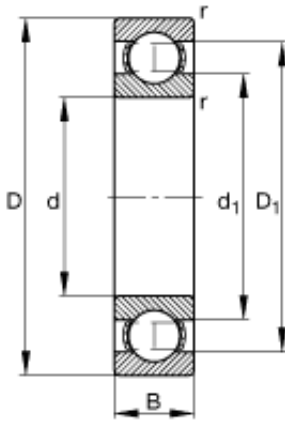

BEARING CORP.

190 mm x 290 mm x 46 mm FAG 6038-M Single Row Ball Bearings

Bearing No. 6038-M



6038-M Bearing 2D drawings and 3D CAD models

Size	190x290x46 mm
Bore Diameter	190 mm
Outer Diameter	290 mm
Width	46 mm
d	190 mm
D	290 mm
B	46 mm
D_1	257,9 mm
$D_{a \max}$	279,8 mm
d_1	222,6 mm
$d_{a \min}$	200,2 mm
$r_{a \max}$	2,1 mm
r_{\min}	2,1 mm
m	11,3 kg / Weight
C_r	216000 N / Dynamic load rating (radial)
C_{0r}	220000 N / Static load rating (radial)
n_G	3850 1/min / Limiting speed
n_B	3100 1/min / Reference speed
C_{ur}	9100 N / Fatigue limit load, radial